

## #203470 Hurricane 200 Driven Shaft Installing

The Main gear assembly should be displaced by the item #203541 which the direction of the one way bearing is different from the Main gear of the belt version #203540.

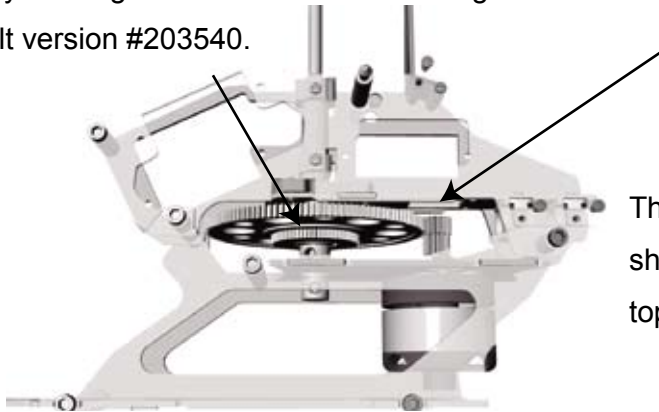

The Middle plate should be displaced by the item above which had the space for pinion gear.

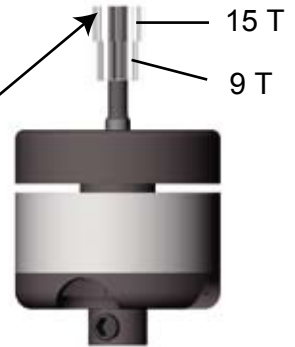

The top of the upper pinion should be aligned with the top of the motor shaft.

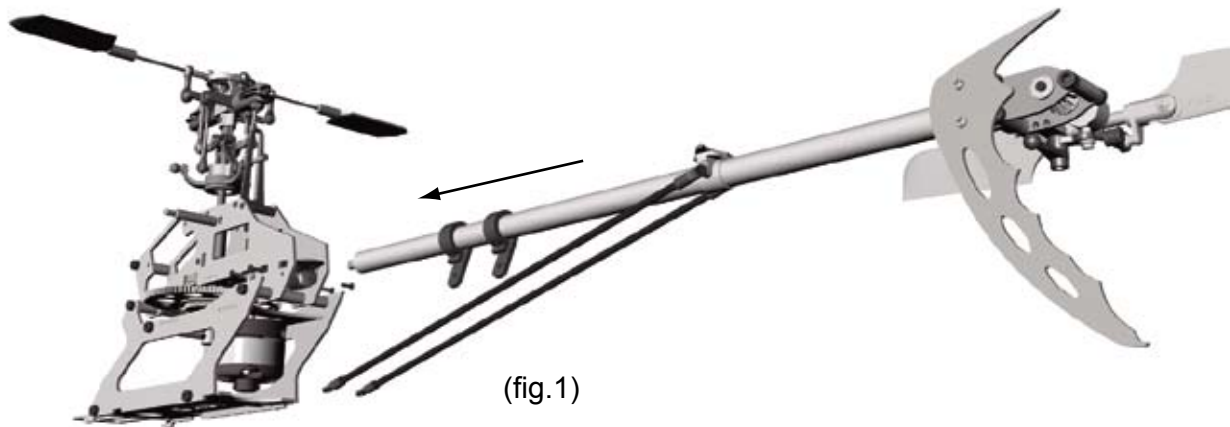

Insert the tail shaft assembly into the boom holder (fig.1), install the crown gear onto the driven shaft , adjust the gear mesh and tighten the screws of the boom holder(fig.2).

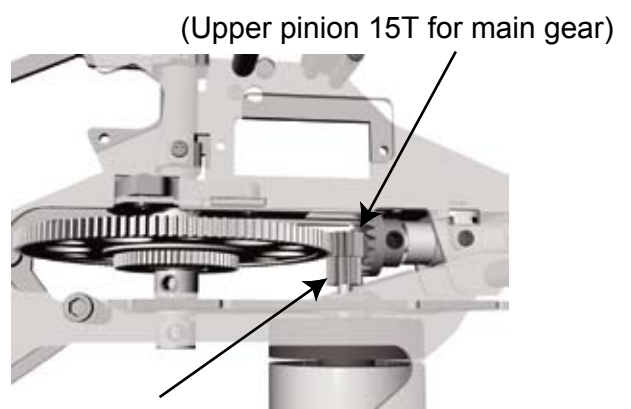
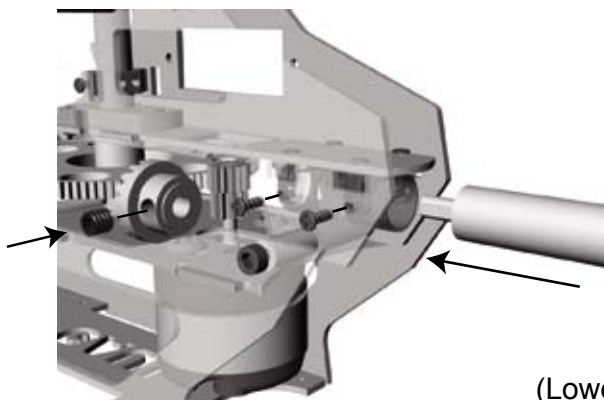

If you use the main gear assembly of the belt version #203540, make sure to reinstall the inside one way bearing up side down and remove the cover. The installing direction of the main gear is different from the belt version as shown in fig.3, the lower pinion must not touch the main gear.