

#203471 Hurricane 200V2 Driven Shaft Installing

Insert the tail shaft assembly into the boom holder, install the crown gear onto the driven shaft, adjust the gear mesh and tighten the screw(M2x5mm) of the boom holder.

- #A #203126 H200SD Crown Gear
- ① W3X4.6X0.5 Washer
 - ② B3X6X2.5 Bearing
 - ③ M2X5 Socket head machine screws

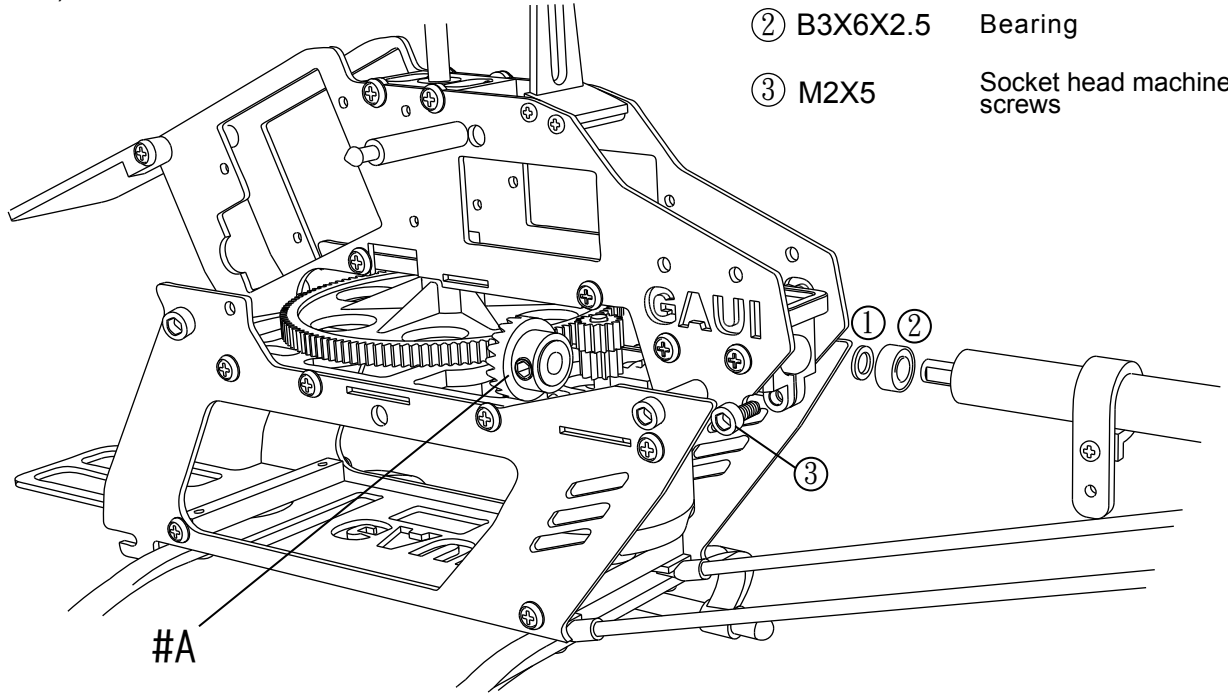

The upper pinion 15T for main gear. The lower pinion 9T for crown gear, the lower pinion must not touch the main gear. Grease the gears after installing for better driving.

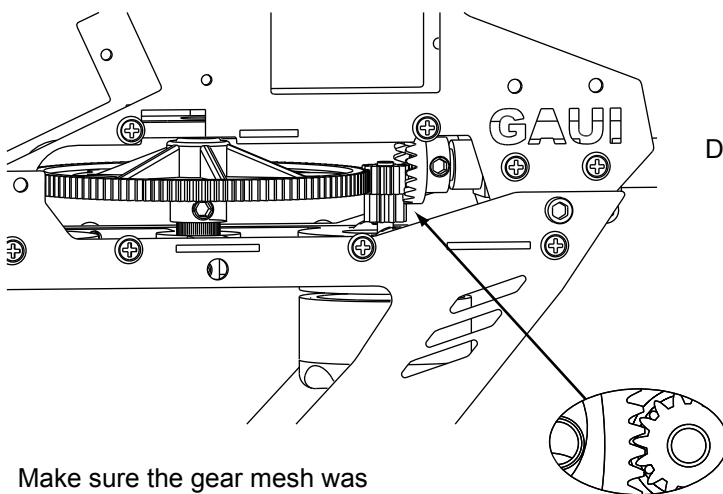

Make sure the gear mesh was set properly (0.1mm approx.)

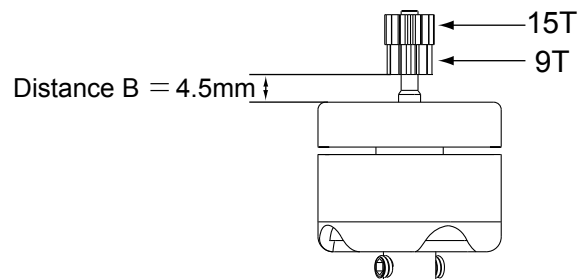

Use Locktite 609 , 680 , or similar material to adhere the long neck pinion gear to the motor shaft. (Make sure the distance B is correct.)

If you use the main gear assembly of the belt version #203540, make sure to reinstall the inside one way bearing up side down and remove the cover. The installing direction of the main gear is different from the belt version as shown in figure above, the lower pinion must not touch the main gear.